

# Jesse Three Drawer

## Assembly Instructions

Thank you for your purchase.

Please follow the instructions below for correct assembly.

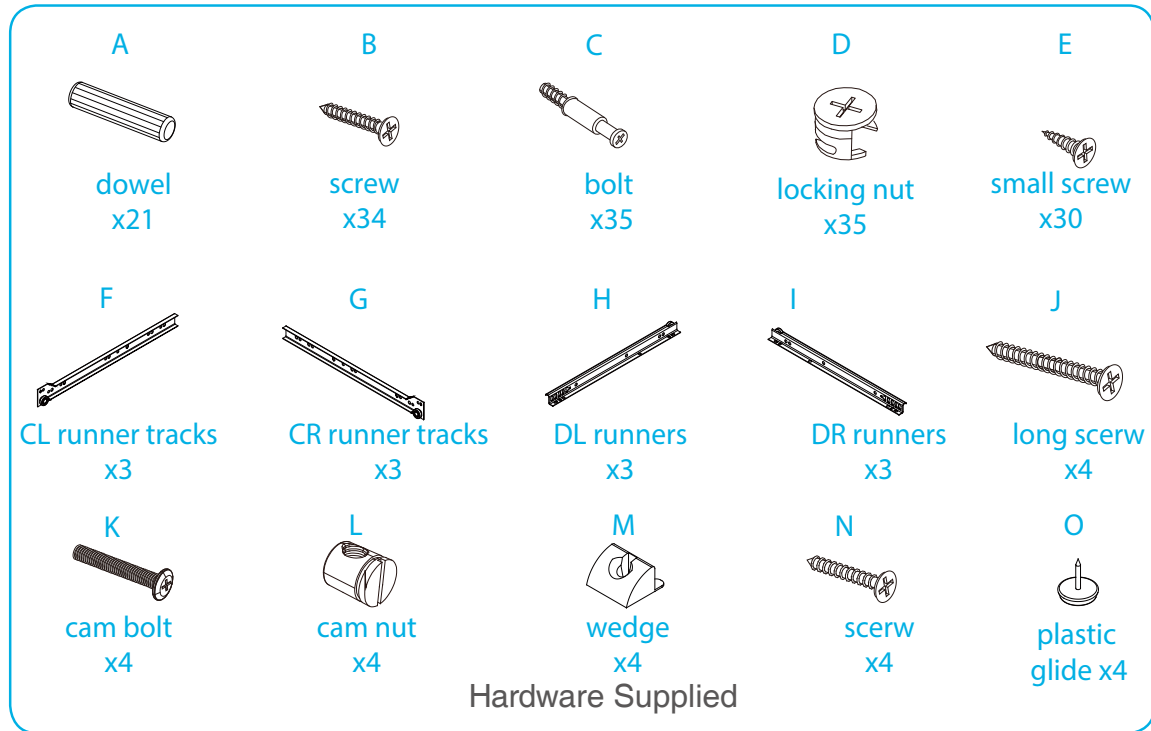

**WARNING:** Any furniture that is not anchored to a wall has the potential to tip over in certain circumstances, i.e. if a child attempts to climb up on the furniture or in the event of an earthquake. Accordingly, we recommend that all furniture is anchored to a wall. We supply a free safety wall anchor with all furniture sold and we recommend these are used to prevent your product tipping. The fixing device provided should fit most wall types, but please note that different wall materials may require different fixing devices from those supplied.

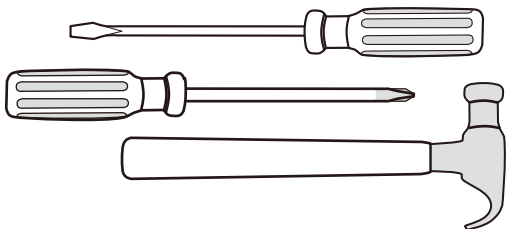

Phillips & Flathead screwdrivers  
and hammer required

For quicker assembly, we recommend the  
use of a power drill on a low-speed setting.

# mocka

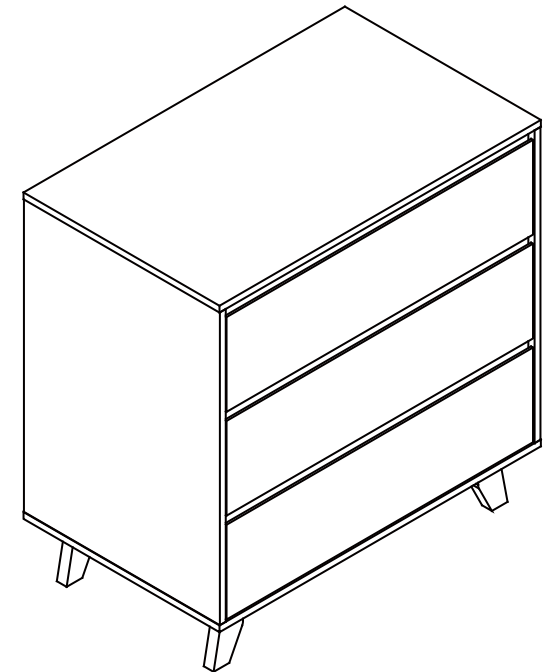
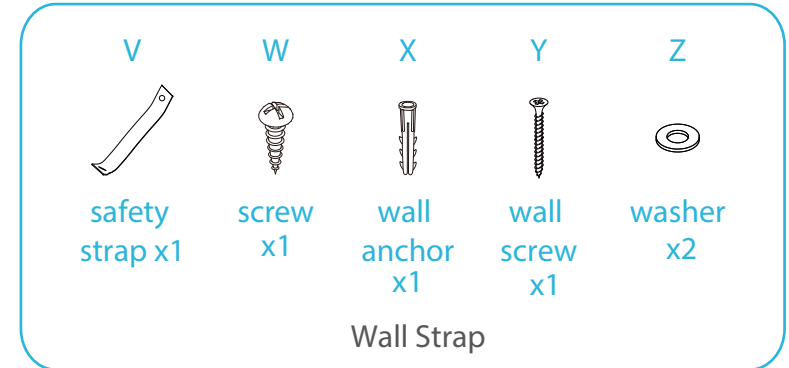

# Jesse Three Drawer

## Assembly Instructions

# mocka

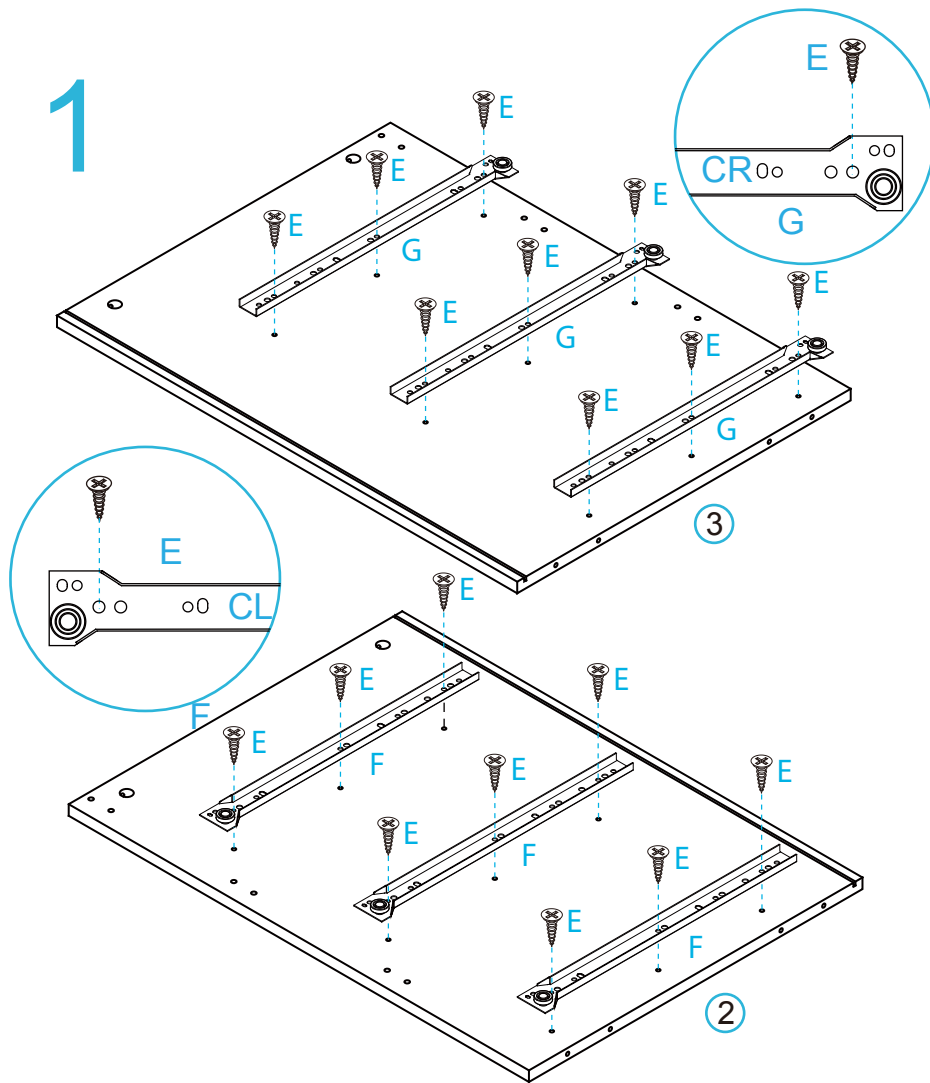

## 2

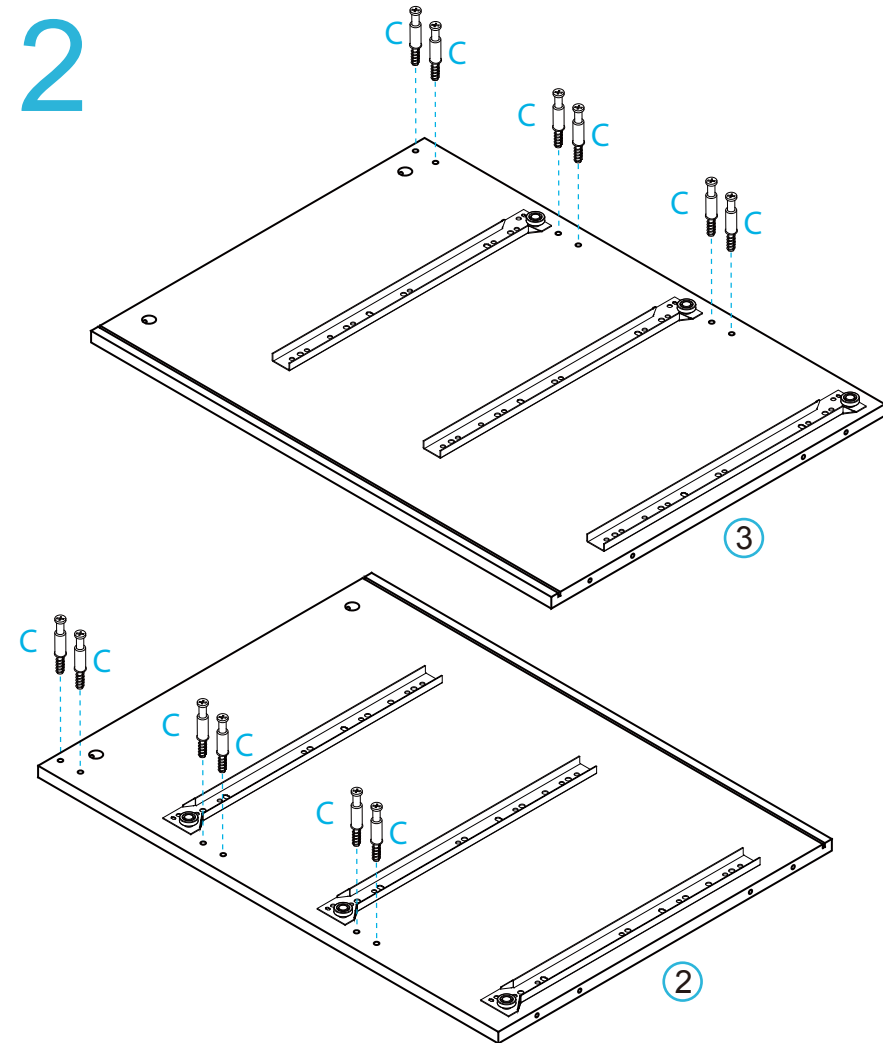

Attach 3xCL runner tracks (F) to panel [2] using 9x small screws (E).  
Attach 3xCR runner tracks (F) to panel [3] using 9x small screws (E).  
Tighten with a screwdriver.

Insert 6x bolts (C) into panel [2]. Insert 6x bolts (C) into panel [3].  
Tighten with a screwdriver.

# Jesse Three Drawer

## Assembly Instructions

mocka

3

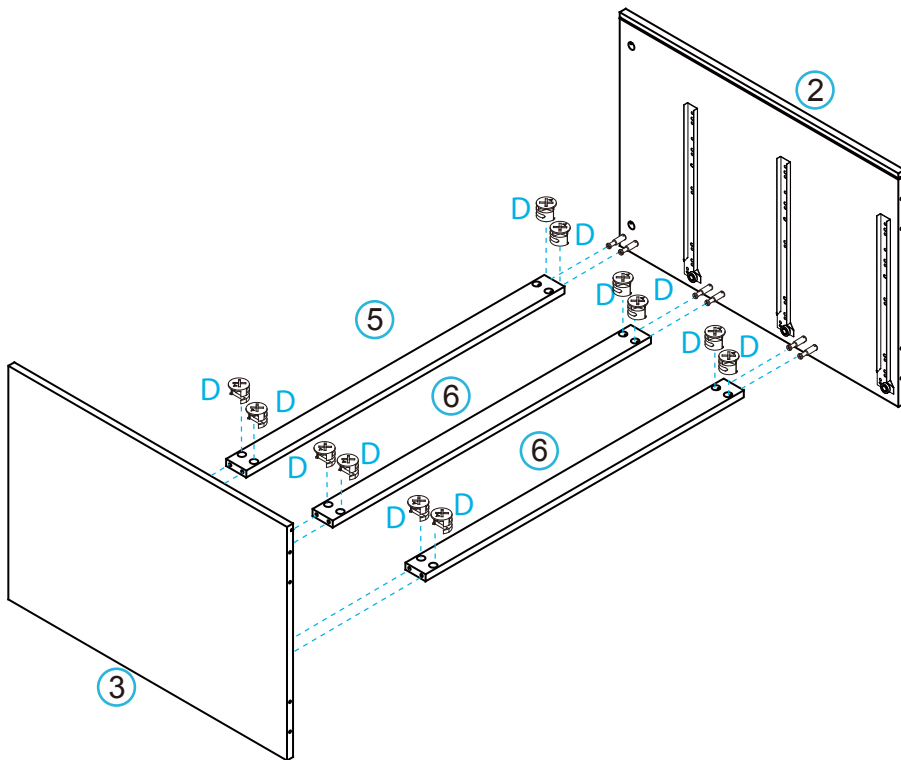

Attach panels [5] and [6] to panels [3] and [2] using 12x locking nuts (D). Tighten with a screwdriver.

4

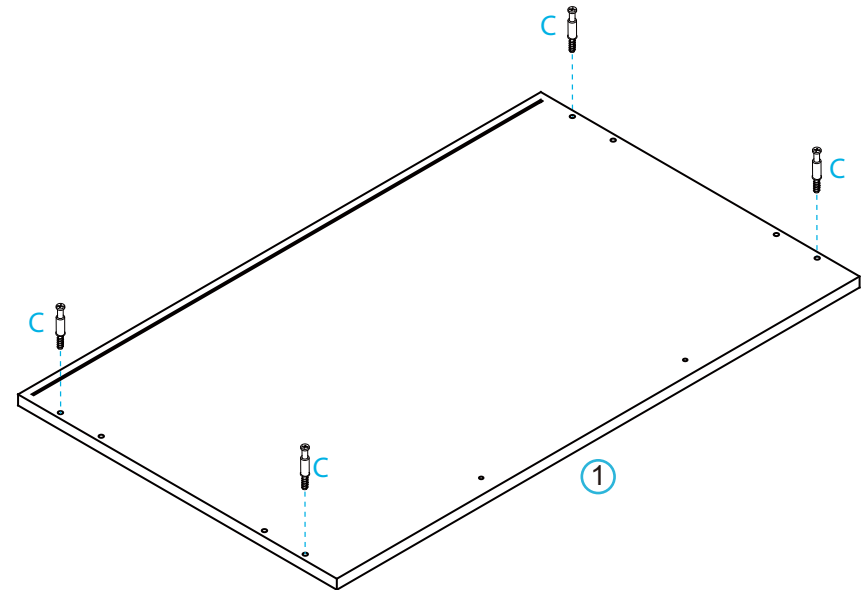

Insert 4x bolts (C) into panel [1]. Tighten with a screwdriver.

# Jesse Three Drawer

## Assembly Instructions

mocka

5

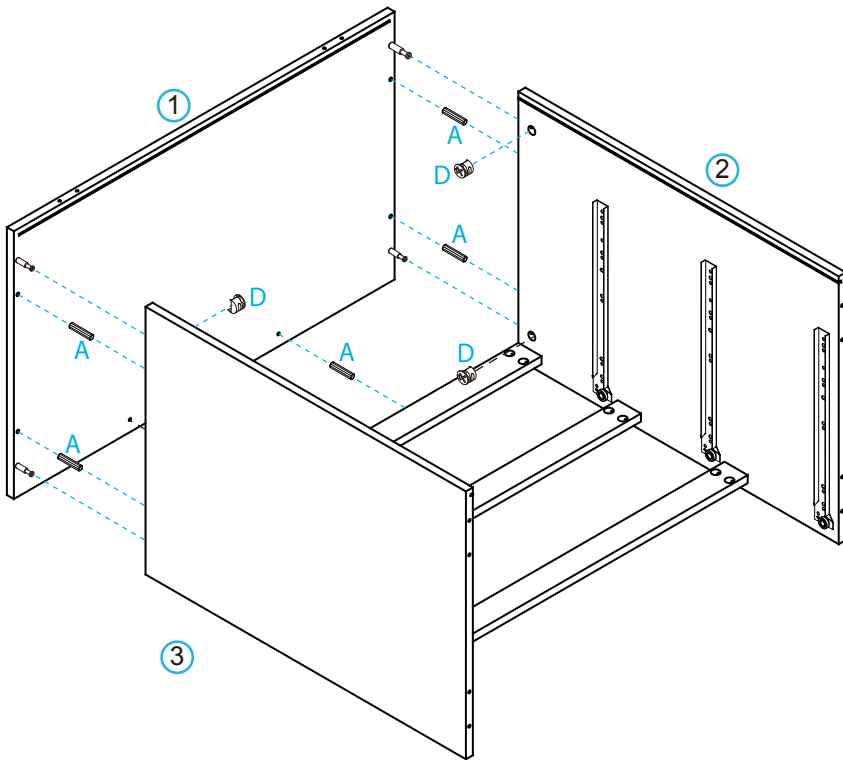

Attach panel [1] to panel [2] , [3] and [5] using 6x dowels (A) and secure with 4x locking nuts (D). Tighten with a screwdriver.

6

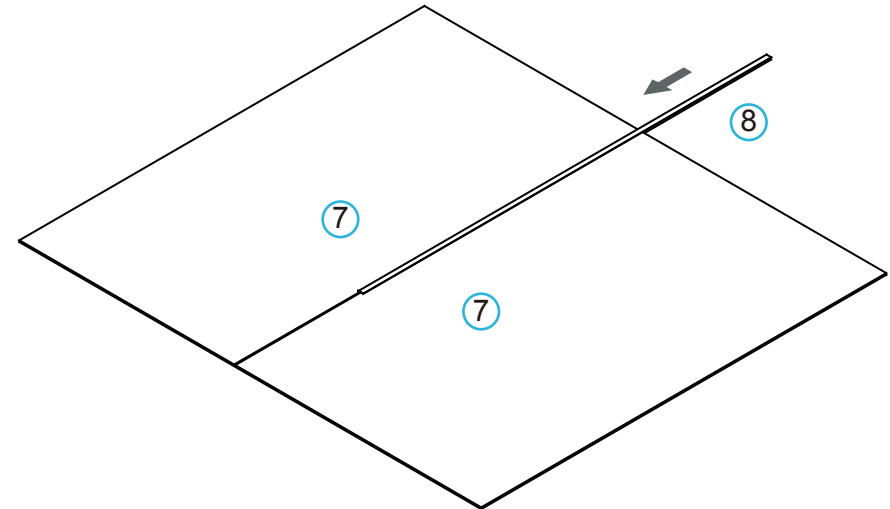

Insert connector [8] to join panels [7].

# Jesse Three Drawer

## Assembly Instructions

mocka

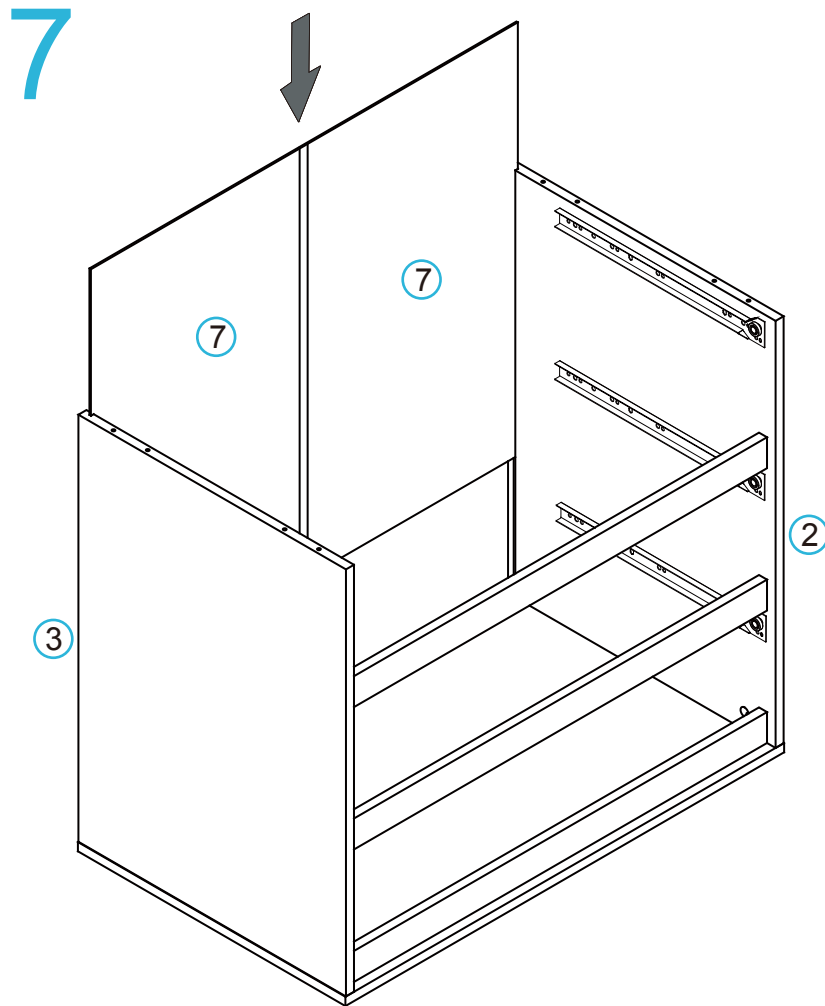

Slide panels [7] along the grooves between the side panels [2] and [3].

8 x2

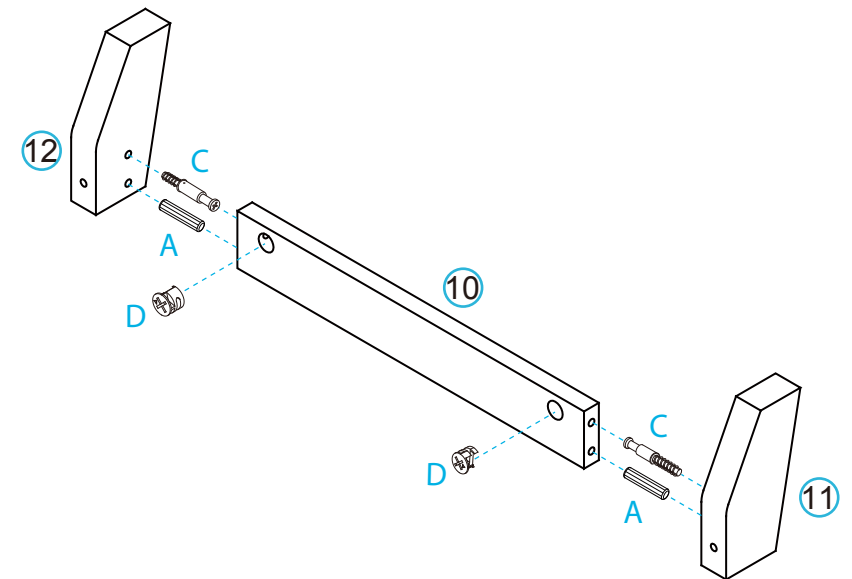

Insert 2x dowels (A) and screw 2x cam bolts (C) into panels [11] and [12]. Attach panel [10], [11] and [12] using 2x locking nuts (D). Tighten with a screwdriver.

# Jesse Three Drawer

## Assembly Instructions

mocka

9

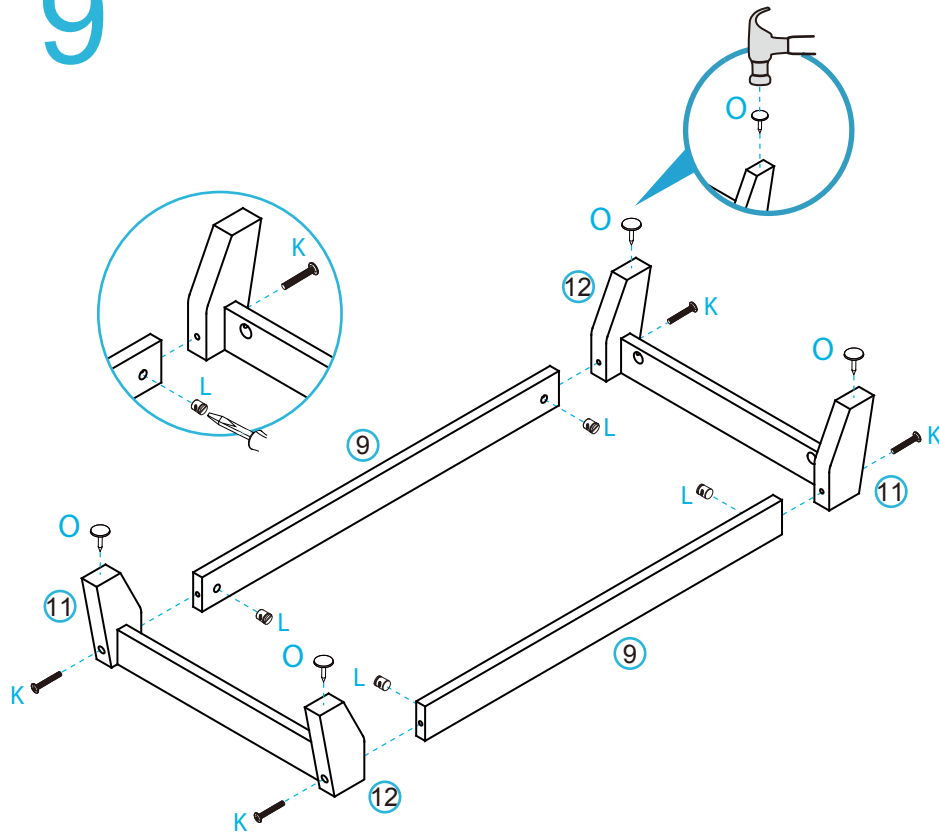

Insert 2x cam nuts (L) into each support panel [9]. Attach panels [11] and [12] to panels [9] using 4x cam bolt (K). Tighten with a screwdriver. Attach 4x plastic glides (O) into the panels with a hammer as shown.

10

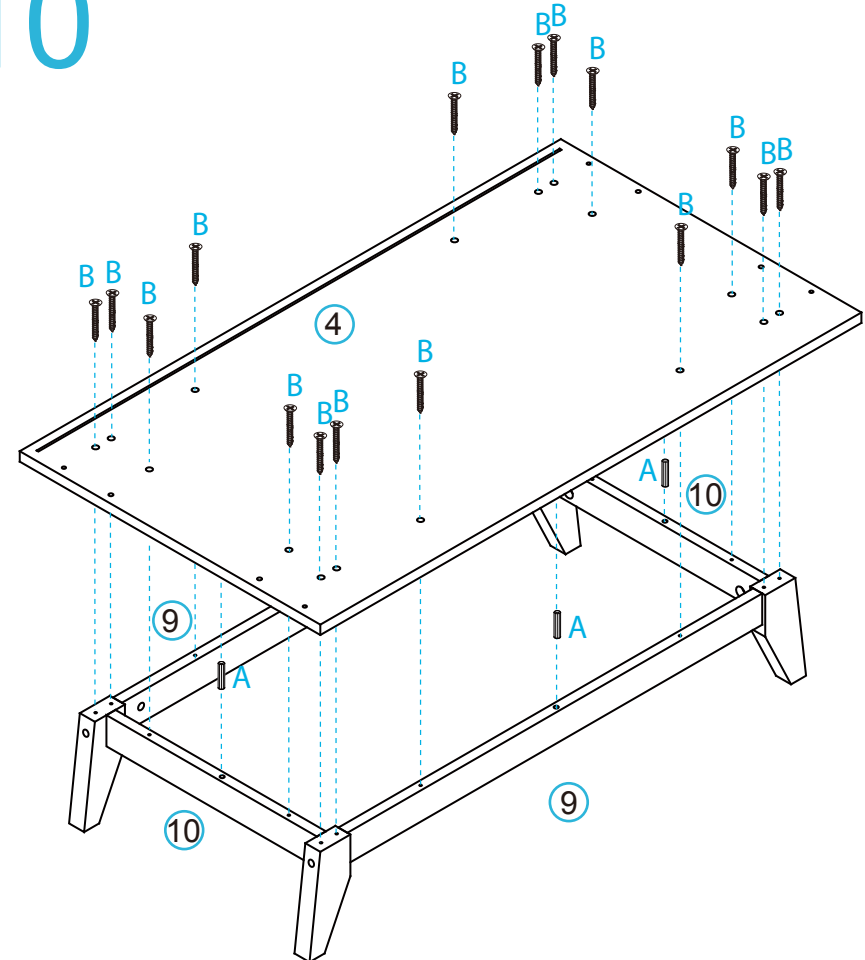

Attach panel [4] to leg panels with 4x dowels (A) and secure with 16x screws (B). Tighten with a screwdriver.

# Jesse Three Drawer

## Assembly Instructions

mocka

11

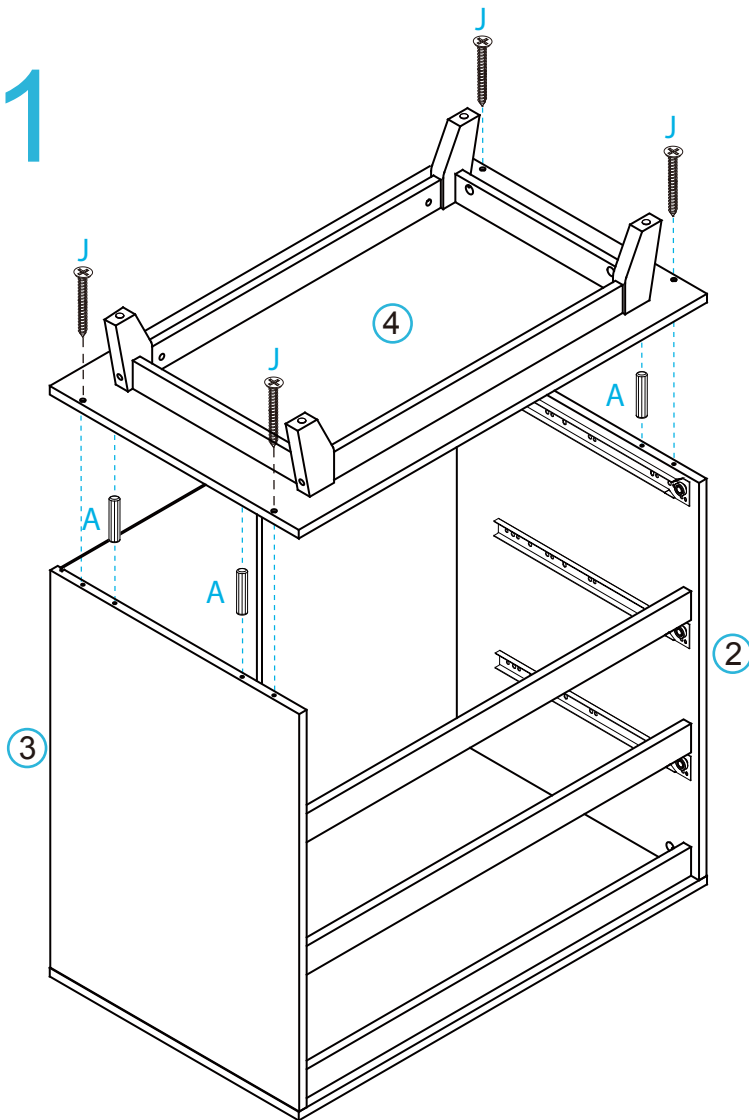

Insert 4x dowels (A) into the top of panel [2] and [3]. Attach the base panel [4] by inserting 4x long screws (J) and tighten with a screwdriver.

12 Drawers x3

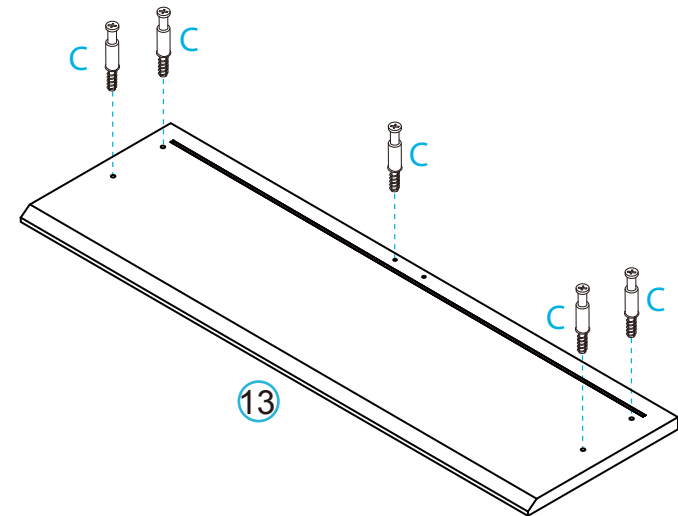

Insert 5x bolts (C) into panel [13]. Tighten with a screwdriver.

# Jesse Three Drawer

## Assembly Instructions

mocka

### 13 Drawers x3

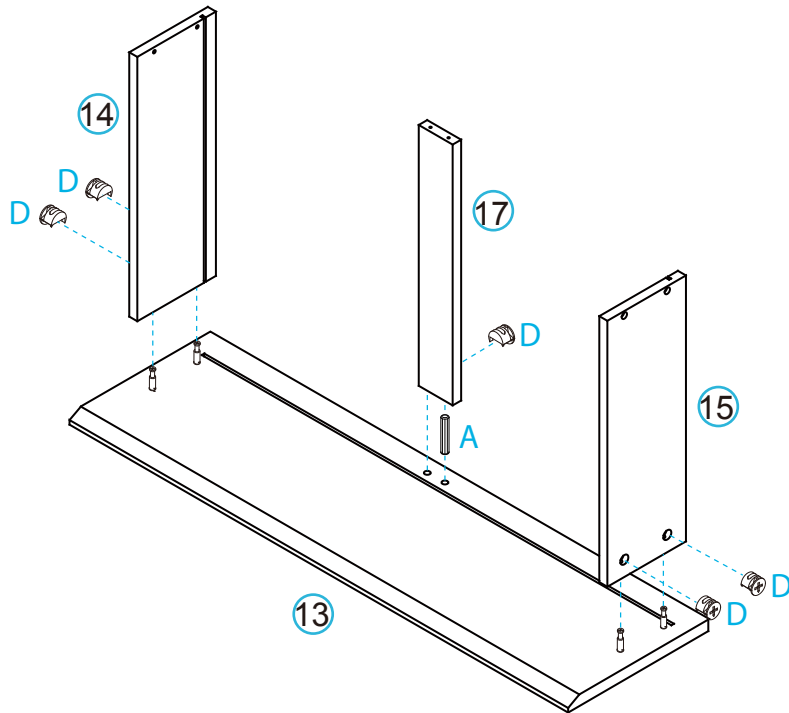

Insert dowel (A) into panel [13]. Attach panels [14], [15] and [17] to panel [13] secure with 5x locking nuts (D). Tighten with a screwdriver.

### 14 Drawers x3

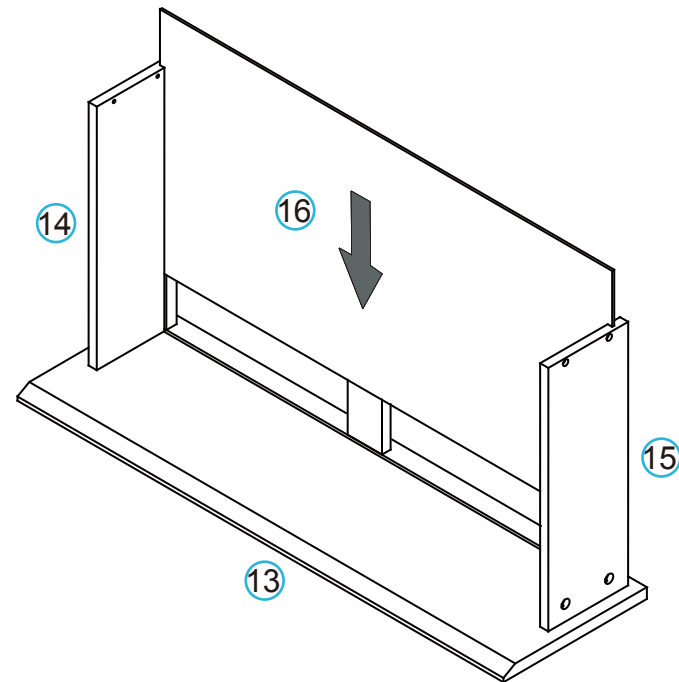

Slide panel [16] along the grooves between the side panels [14] and [15] to form the base of the drawer.



# Jesse Three Drawer

## Assembly Instructions

### 15 Drawers x3

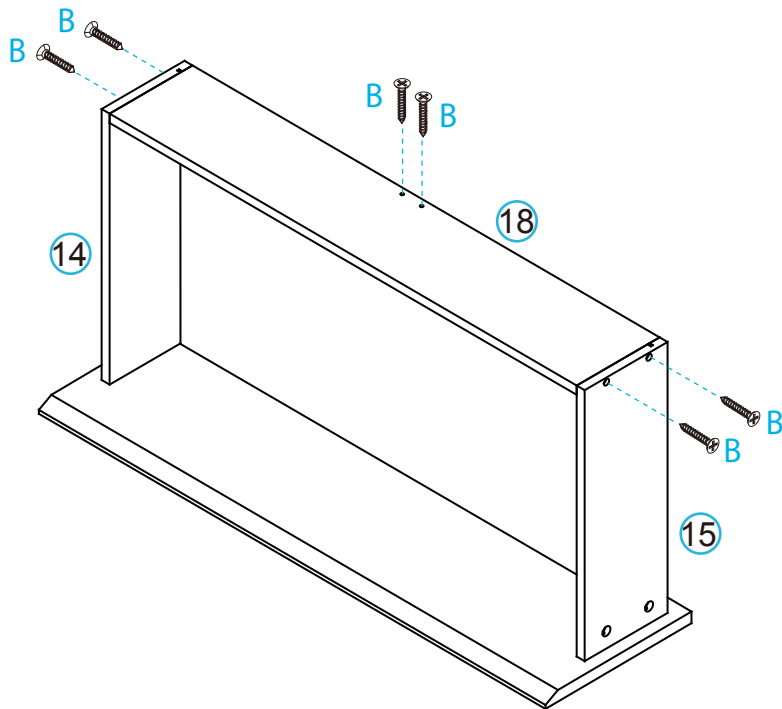

Attach panels [14], [15] and [18] as shown using 6x screws (B). Tighten with a screwdriver.

# mocka

### 16 Drawers x3

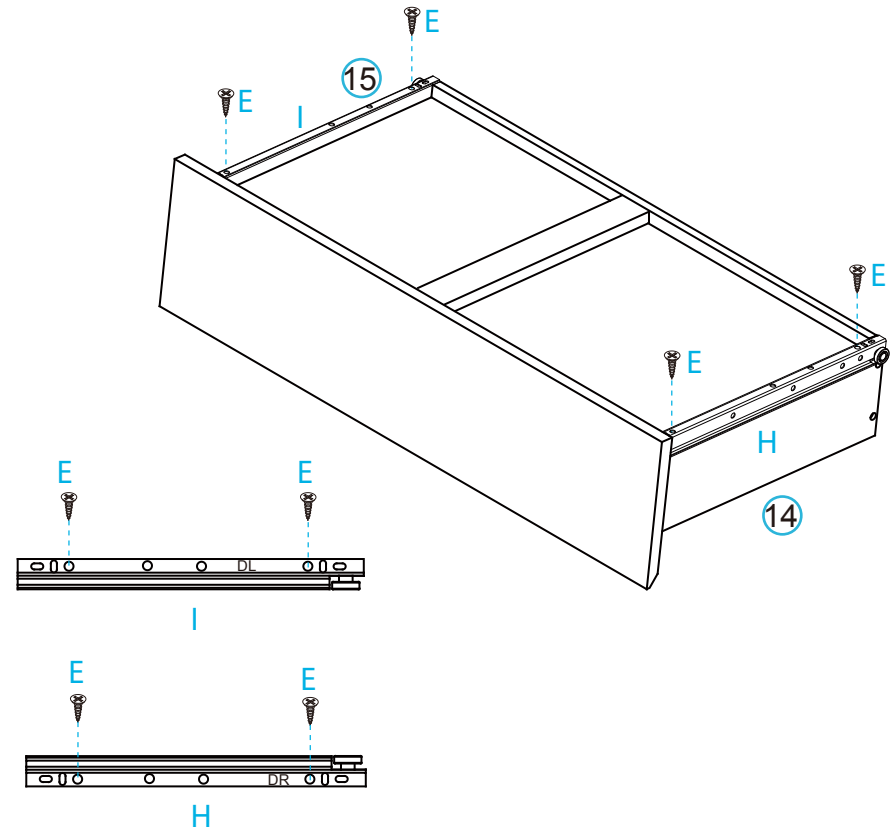

Attach slide rails (I) and slide rails (H) to the underside of the side panels as shown. Secure with 4x screws (E) and tighten with a screwdriver.

# Jesse Three Drawer

## Assembly Instructions

# mocka

# 17

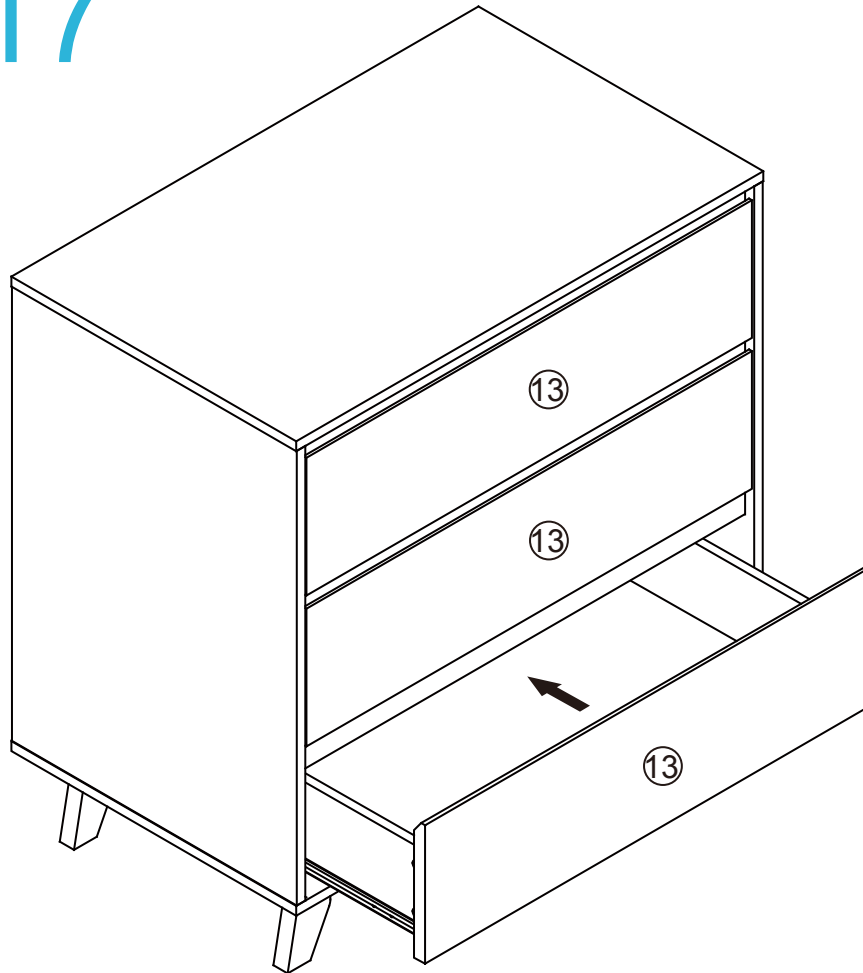

Insert the assembled drawers into the corresponding compartments as shown. Ensure the drawers slide easily along the rails.

# 18

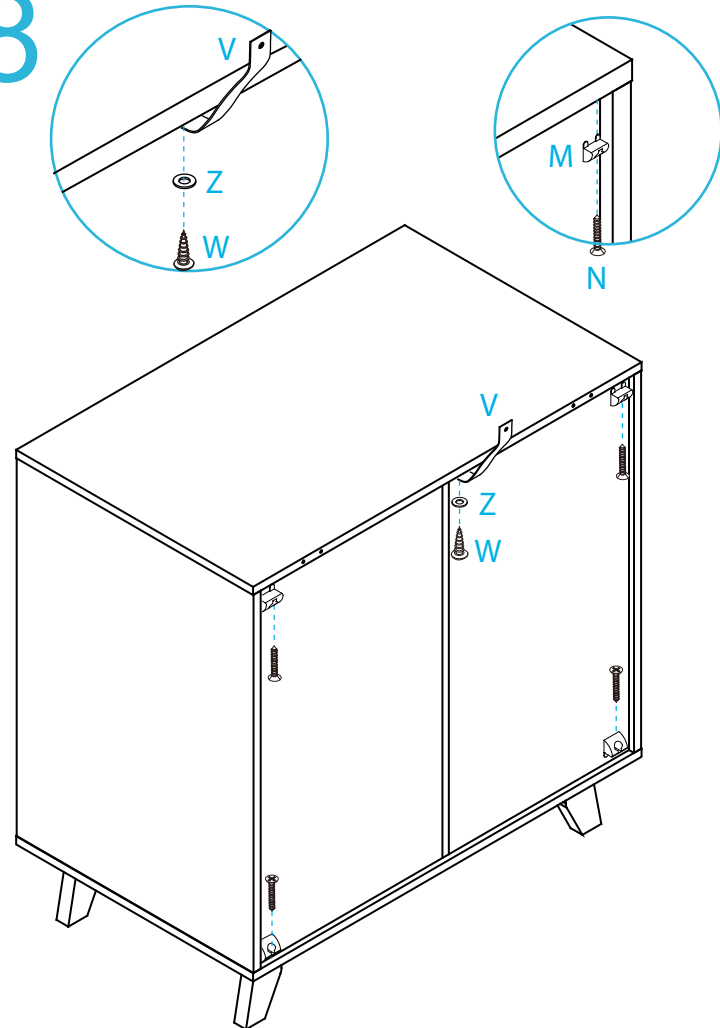

Attach 4x wedges (M) into the corners of the back of the unit and secure with 4x screws (N). Tighten with a screwdriver. Attach 1x safety strap (V) to the top of the back side of the unit as shown using 1x washer (Z) and 1x screw (W). Tighten with a screwdriver.

# Jesse Three Drawer

## Assembly Instructions

mocka

19

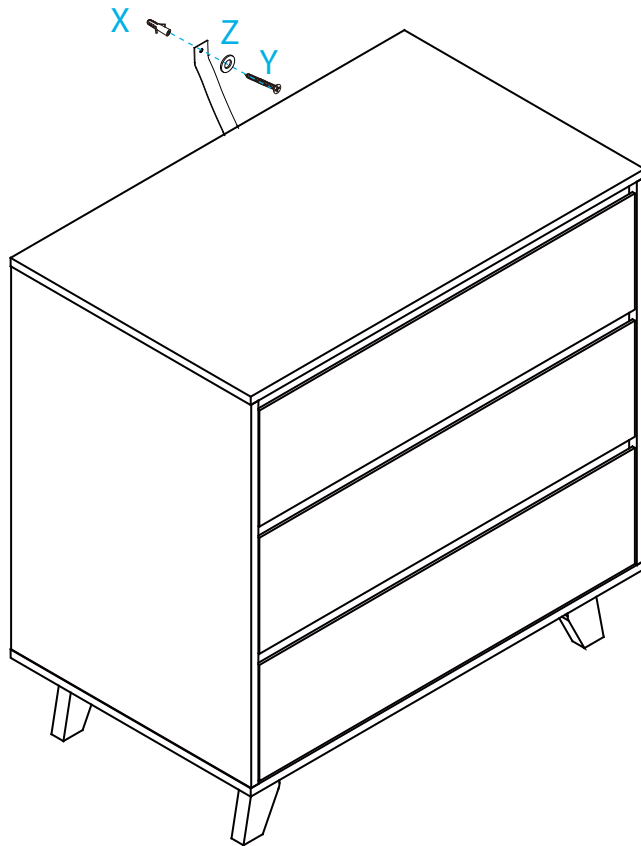

20

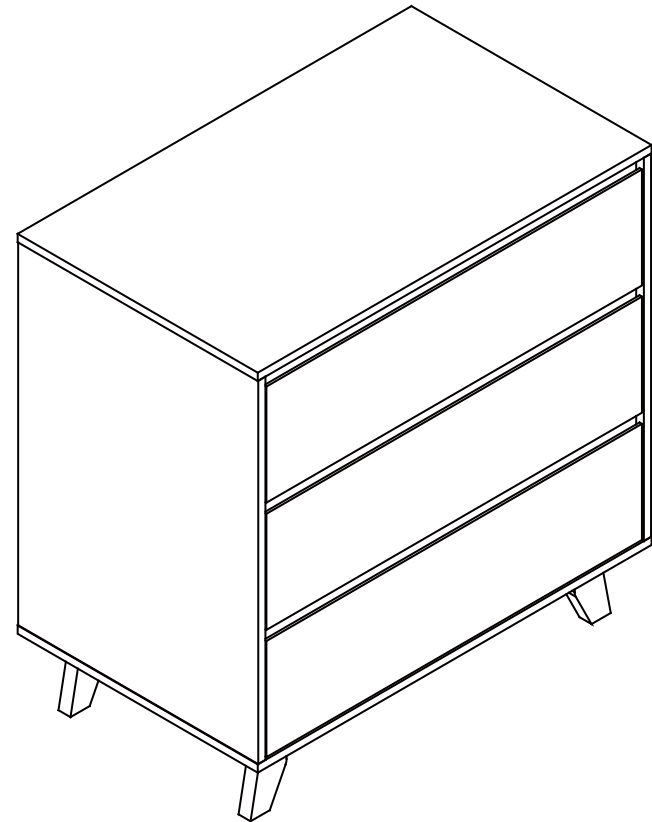

Once assembled lift furniture into place, do not drag. Use a drill to create a small hole lining up with the top of the safety strap (V). Fasten to wall using 1x washer (Z), 1x wall plug (X) and 1x screw (Y). Ensure unit is balanced and steady before use.

You're done,enjoy!